

KILLER APPLETS

UPB Home Automation Control

Basement Lights OFF

BENEFITS

- **Save energy — turn off unnecessary lights to save your energy as well as valuable natural resources**
- **Easily installed using:**
 - 1 tabletop controller
 - One or more controlled lights
 - Intelligent controller (optional)
 - 1 Computer interface module (optional)

Turn off lights your kids (or spouse) leave on.

DO YOUR KIDS drive you crazy by leaving basement (or other) lights on even when the basement is no longer in use?

Use a convenient tabletop controller along with light switches and/or lamp modules to take control of untended lights.

Your tabletop (or wall mount) controller can show you when any lights in certain rooms are on. If you know the room is no longer in use, click the appropriate button on the multi-button controller to turn all lights in that room off.

No need to be frustrated when other family members aren't as conscious of wasteful lighting as you are—take control yourself without getting out of bed!

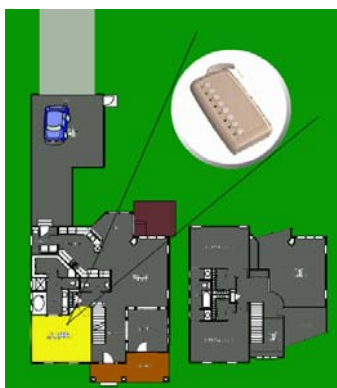
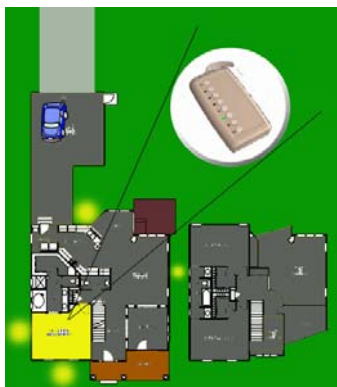

WHAT IS A KILLER APPLETS?

"Killer App" is industry jargon for an application that persuades users to buy the system it runs on.

There is no single killer app for home control, but there are many Killer Applets — UPB-based applications that can satisfy your individual needs.

Take a look at our collection of Killer Applets and we think you'll agree: home automation using UPB is the right choice to enhance the safety, security, and comfort of your home.

For UPB product information email us at:

info@webmtn.com.

For immediate attention call: **720-207-9174**.

With an intelligent controller, such as the Web Mountain NetPlace server, you could automatically turn all lights off late at night when it's certain those lights are no longer needed.